

# *Pioneer*

## VREC-Z410DH

### DASH CAMERA

### Quick Start Guide

**PIONEER INDIA ELECTRONICS PRIVATE LIMITED**

Unit No. 3, 10th Floor, Ambience Corporate Tower – 2,  
Plot no. 3, Ambience Island,  
NH-8, Gurugram, Haryana 122002, India  
Tel : +91 124 4636100

© 2025 PIONEER CORPORATION

This guide is intended to explain you the basic functions of this unit. For details, please refer to the Owner's manual stored on the website.

***<https://pioneer-india.in/>***

#### **After-Sales Service for Pioneer Products**

Please contact the authorized Pioneer dealer from which you purchased this unit or an authorized Pioneer service company for after-sales service or questions you may have about the product. You may contact Pioneer directly as follows:

#### **PIONEER INDIA ELECTRONICS PRIVATE LIMITED**

Unit No. 3, 10th Floor, Ambience Corporate Tower – 2, Plot no. 3, Ambience Island, NH-8, Gurugram, Haryana 122002, India

**Tel : +91 124 463 6100 / Toll Free : 1800-103-5787**

**Do not ship your unit in for repair without contacting Pioneer first. Always produce the warranty card with serial number affixed on it. Units sent without a return authorization number or without serial number will be refused.**

For Warranty information, please see the Limited Warranty sheet included with this unit.

## Precautions

When disposing of products, please comply with governmental regulations or environmental public institution's rules that apply in your country / area

### Safety precautions

Certain country, state and provincial laws may prohibit or restrict the placement and use of this product in your vehicle. Please comply with all applicable laws and regulations regarding the use, installation and operation of this product. It is the user's responsibility to comply with all applicable laws, rules, regulations and ordinances.

#### Warning

- Do not install this product in your vehicle if its location or use would obstruct the driver's clear view of the road or the operation of any airbag in the vehicle. It is also the owner's / driver's responsibility to know and comply with the laws rules, and regulations of the driving location, including, for example, passenger privacy rights. And not to use the device in any location where its installation or use is prohibited.
- Do not use this device to make audio or video recordings prohibited in the location where you are using this product. Always provide notice that is required in your location that video and audio recordings (if audio is in use) are being made and obtain appropriate consent and authorization from the persons being recorded. Some states, provinces and municipalities require posting a visible written notice that occupants and conversations are being recorded.

#### CAUTION

The graphical symbol  placed on the product means direct current.

When disposing of used batteries, please comply with governmental regulations or environmental public institution's rules that apply in your country / area.



## **WARNING**

- Do not allow this product to come into contact with liquids. This can cause electrical shock. Contact with liquids can also cause smoke, overheating and damage to the product.

### **Before using this product, be sure to read and fully understand the following safety information:**

- Don't use this product if it will distract you from safely operating your vehicle. Always observe safe driving rules and follow all existing traffic regulations. If you experience difficulty in operating this product or reading the display, park your vehicle in a safe location and apply the parking brake before making the necessary adjustments.
- Certain functions (such as viewing of screen and certain button operations) offered by this product could be dangerous (possibly resulting in serious injury or death) and/or unlawful if used while driving.

### **Precautions before connecting the system:**

## **WARNING**

- Securely install this product on the front windshield to prevent it from falling off. If this product is not firmly installed, it may fall off the windshield while driving and cause an accident. Periodically inspect this product.
- Pioneer recommends that only authorized service company personnel, who have special training and experience in mobile electronics, set up and install this product.
- Secure all wiring with cable clamps or electrical tape. Do not allow any bare wiring to remain exposed

### **Precautions before installation:**

## **WARNING**

- Do not install this product where it may:
  - I. obstruct the driver's vision.
  - II. impair the performance of any of the vehicle's operating systems or safety features, including airbags, hazard lamp buttons or
  - III. impair the driver's ability to safely operate the vehicle.
- Do not install this product near the dashboard, door, or pillar where an airbag is deployed. Please refer to your vehicle owner's manual carefully for reference to the deployment area of the airbags.

## **CAUTION**

- To ensure proper installation, be sure to use the supplied parts in the manner specified. If any parts are not supplied with this product, use compatible parts in the manner specified after you have the parts' compatibility checked by your dealer. If parts other than supplied or compatible ones are used, they may damage internal parts of this product or they may work loose, and the product may become detached. Also, please note that the product may not function properly in case non-compatible accessories are used.
- Do not install this product in places subject to high temperatures or humidity, such as:
  - I. Places close to a heater, vent, or air conditioner.
  - II. Places that may be exposed to rain, such as close to the door.

## Packaging Contents

1x Dash Camera [VREC-Z410DH], 1x Hardwire Kit, 2x Electrostatic Film, 1x Mount with adhesive, 1x Rear Camera, 1x Rear Camera Connecting Cable (Length 7 meter), 1x Quick Start Guide, 1x Pry Tool, 1x Warranty Card

## Product Appearance

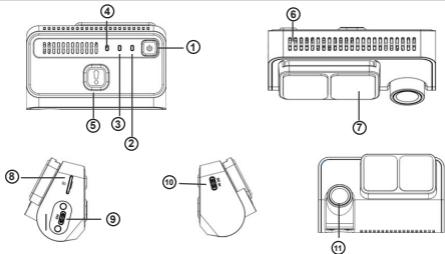

- |    |                           |     |                                     |
|----|---------------------------|-----|-------------------------------------|
| 1. | ON/OFF Power Button       | 7.  | Mounting                            |
| 2. | Status Indicator          | 8.  | microSD™ Card Slot                  |
| 3. | Mic Indicator             | 9.  | Rear Camera Power Input             |
| 4. | Video Recording Indicator | 10. | Power port (to connect power cable) |
| 5. | Alert button              | 11. | Camera Lens                         |
| 6. | Air Vents                 |     |                                     |

## Product Specifications

**Resolution:** 3K 3008p (5MP Front); 1080p/Full HD (Rear)

**Wi-Fi:** In-built (2.4 GHz)

**BLE Support:** Yes (5.3 version)

**G-sensor:** Supported

**GPS:** Supported

**Storage:** microSD Card (Class 10 or above; up to 1TB)

**Power Supply:** 5 V, 2.0 A (via cigarette charger slot of vehicle or via Hardwire Kit)

**Power Connector:** USB Type-C®

**Power Back-up:** Super Capacitor

## Dashcam System Indicators & Alerts

The operating status of this product is displayed with the system indicator.

### Recording Functions

LED Type	Recording Started	Manual Alert Recording	Impact Event Detected
REC LED	Green Solid	Green Flashing/ Blinking	Green Flashing/ Blinking
Meaning	Normal recording active	User-triggered alert recording.	Sensor-triggered event recording

### Audio Control Functions

LED Type	Microphone ON	Microphone OFF
REC LED	Green Solid	Green Solid
MIC LED	Green Solid	Red Solid
Meaning	Audio enabled. Both REC & MIC solid green which indicates recording is taking place and MIC is recording Audio	Audio muted. REC green solid, MIC red solid which indicates recording is taking place and MIC is recording Audio

### Connectivity Functions

LED Type	Microphone ON	Microphone OFF
REC LED	Red Flashing/Blinking	Green Solid
Status LED	Yellow Solid	Green Solid
Meaning	Hotspot mode active. REC red blink, status yellow solid which mean Wifi is connected but Recording has stopped	Bluetooth control active. REC red blink, status green solid which means device is connected to app and Recording has stopped

### Bluetooth Pairing Functions

LED Type	Enter Pairing Mode	Paired Successfully
Status LED	Blue Flashing/Blinking	Blue Solid
Meaning	Dashcam discoverable. Status blue blinking which means Bluetooth is in pairing mode	Connection established. Status blue solid which means Bluetooth is paired

## Function Buttons

There are 2 function buttons on the back of the dash camera.

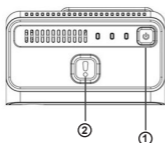

- 1 Power Button
- 2 Alert Button

### Power Button

Function	REC LED	MIC LED	Status LED	Voice Prompt
Single-press Power Button (Toggle Wi-Fi)	Solid green	Alternating green/red (solid)	Blinks for 5 seconds, then turns off	"Wi-Fi turned on/off"
Double-press Power Button (Toggle Microphone)	Solid green	Alternating green/red (Flashing)	Blinks for 30 seconds, then turns off	"Audio recording on/off"
Triple-press Power Button (Start SD Card Format)	Flashing red	Off	Off	"Formatting SD card"

### Alert Button

One-press Alert helps you capture and secure important video clips without taking your eyes off the road:

- 1. Instant Event Capture:** Press once to save the 30 seconds before and after (total 1 min of recording) the event and sends a SMS alert to your added contact with your GPS coordinates.
- 2. Easy Flagging:** Automatically tags the clip as an alert event for quick review in your app.
- 3. Effortless Sharing:** Locate and share Alert clips instantly, so you can send critical footage to friends, family, or insurance with minimal taps.

Stay focused on driving-our Alert button guarantees you never miss a moment worth saving.

1. Press the Alert button.



2. The system will:

- Save a video clip covering 30 seconds before and after the press.
- Text your emergency contact with your exact GPS coordinates.

## Function Buttons

### Note

#### 1) Wi-Fi Will Temporarily Disable

When you press the Alert button:

- Your mobile device's Wi-Fi will automatically turn off to prioritize emergency signals.
- *Reconnect manually afterward if needed.*

#### 2) Bluetooth Connection Required

For Alert button to work:

- Your Dashcam must be connected to your mobile device via Bluetooth for this feature to work
- *Check your Bluetooth connection status before starting your journey.*

## Installation

### Installing the microSD™ card

#### Note:

1. microSD™ card to be purchased separately
2. Use a Class 10 or above microSD card for proper functionality. Due to continuous recording, we strongly recommend using a high-performance, endurance-grade microSD card. These cards are designed to withstand frequent read/write cycles, ensuring reliable performance and minimizing the risk of missed recordings—especially during crucial moments such as accidents.
3. You will not be able to record videos without microSD card.
4. You shall be prompted to format the microSD card after inserting it first time into the dash camera.

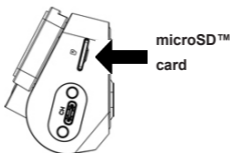

#### Note:

1. microSD card to be purchased separately.
2. Use a class 10 or above microSD card for proper functionality.
3. You will not be able to record videos without microSD card.
4. You shall be prompted to format the microSD card after inserting it first time into the dash camera.

## Specified Installation Position on Front Windshield

When installing this product in your vehicle, please be mindful of the position on the front windshield. Install in a way that satisfies any prescribed or applicable laws at your location and also following conditions:

- Install in a 7-inch/17.8 cm square in the lower corner of the windshield farthest from the driver, a 5-inch/12.7 cm square in the lower corner of the windshield nearest to the driver and outside of any airbag deployment zone, or in a 5-inch/12.7 cm square mounted to the center uppermost portion of the interior of the windshield. The ideal location is behind the rearview mirror out of the driver's view as shown below.
- A position where this entire product is within 20% of the top edge of the height of the front windshield or are in the shadow of the rear-view mirror as viewed from the driver's seat. Note that "20%" as described above is a rough estimate. Please install the product in accordance with your location's laws and regulations.
- A position where the lens part of this product is within the wiping range of the wiper.
- A position where the lens part of this product does not hang over the sunshade and black ceramic lines/black ceramic pattern.
- A position where this product faces in the horizontal direction to the front and side to side.

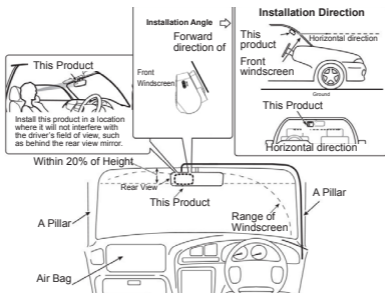

Always install this product in the specified installation position to ensure a safe field of view while driving and to achieve full performance from the product. Pioneer is not liable for any damages due to faulty or improper installation or use of the product.

- For vehicles equipped with driver-assistance systems, there may be areas where the installation of accessory items is prohibited. For details, please refer to the instruction manual of your vehicle.
- Installing the Dash Camera main unit or cables near the film antenna element may affect the TV reception sensitivity.

## Recommended Installation Position on Rear Windshield

When installing the rear camera inside the rear window, it is recommended to mount it in a position that meets all of the following conditions.

- A position where the lens part of the rear camera is within the wiping range of the wiper.
- A position where the rear camera faces in the horizontal direction to the rear and side to side.
- A position where the lens part of the rear camera and the double-sided tape do not overlap the heating wires.
- A position where the rear camera connection cable can be routed without unnecessary force.

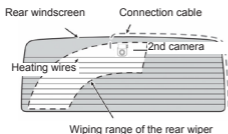

### Installing the rear camera

The top and bottom of the image can be set according to the mounting direction of the rear camera

1. **Clean the installation area of dirt and oils using a clean cloth.**

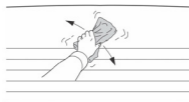

- Take the smaller Electrostatic film supplied in the packaging.
- Peel-off the protective film off the electrostatic film.
- Align the protective film position on the windshield as per recommended place of installation.
- Fix the film in a straight line horizontally and vertically.

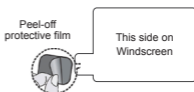

### 2. Install the rear camera.

- ① Peel off the double-sided tape release paper from the rear camera.

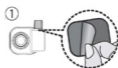

### ⚠ CAUTION

- Make sure that the surface of the rear windshield is clean and dry, before attaching the rear camera.
- Use extreme care as the double-sided tape on the rear camera is extremely strong, and should not be reapplied once it has been applied.
- To ensure the installation strength of the adhesive tape, leave this product for 24 hours after application before using it.

### Note

- A protective film is applied to the lens when the product is purchased. Peel off this film.

## Installing the Dash Camera

1. Clean the installation area of dirt and oils using a clean cloth.



- Take the bigger Electrostatic film supplied in the packaging.
- Peel-off the protective film off the electrostatic film.
- Align the protective film position on the windshield as per recommended place of installation.
- Fix the film in a straight line horizontally and vertically.

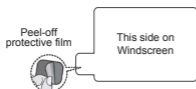

2. Install this product.

Peel off the double-sided tape release paper from the dash camera mount.



Install at the specified position of the front windshield.

Firmly push this



### **CAUTION**

- Make sure that the surface of the front windshield is clean and dry, before attaching the dash camera mount.
- Use extreme care as the double-sided tape on the dash camera mount is extremely strong, and should not be reapplied once it has been applied.
- For optimal tape adhesion, it is recommended that the product remains undisturbed in the vehicle for about 24 hours, and avoiding any shock during driving.

### **Note**

- A protective film is applied to the lens when the product is purchased. Peel off this film.

## Installing the Dash Camera

### 3. Connecting the cables.

- Connect the power cable to the power adapter and main unit.

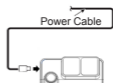

- Route the power cable via A column as shown below.

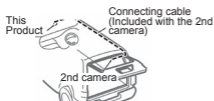

- Please route the cable of rear camera via ceiling only.
- Connect the USB power adapter to cigarette lighter socket of the vehicle. Fully insert this into the vehicle accessory socket to make a good connection. (The location of the accessory socket will differ depending on the vehicle).

### **⚠ CAUTION**

- The accessory socket may be extremely hot immediately after connecting the adapter into the accessory socket. The tip of the power cable may melt or short circuit if it is plugged in while the socket is hot. Ensure that the socket is cool before plugging in the cigarette lighter power cable.
- Use only with 12V vehicle accessory cigarette lighter socket or USB port to avoid damage/malfunction.

### 4. Adjust the angles

Adjust your camera to cover your entire vehicle and surroundings – this way you'll capture everything important during an incident.



### 5. Switch on the ignition

Switch on the ignition to check if the installed product is working as expected.

## Direct connection with Vehicle Battery (Parking mode)

Be sure to disconnect the  $\ominus$  terminal of the vehicle's battery before connecting the power cable.

Parking mode can be enabled on this dash camera for which user have to purchase a Hardwire Kit and get it installed by a trained automobile technician. By using the power cable to draw power directly from the vehicle, this product can detect and record vehicle movement caused by vibration even when the vehicle's ignition is turned OFF. It is recommended to use a power cable (or Hardwire Kit) with fuse.

In case you switch back to USB power adaptor (from Hardwire kit) to power the dash camera, please note to perform factory-reset operation using App or Dash Camera GUI.

If factory-reset is not performed, the dash camera may not work properly or may seem to be shut down.

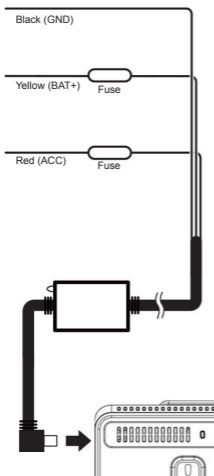

### Ground (Black)

Securely connect to the metal part of the vehicle body. To prevent noise, connect as close to the navigation unit as possible.

### + Battery power supply (Yellow)

Always connect to the power circuit supplied with power from the battery, regardless of whether the vehicle engine switch is ON or OFF.

### Accessory power supply (Red)

Connect to the power circuit supplied with power when the vehicle engine switch is turned to the ACC position. Never install the accessory power supply to a vehicle that does not have an ACC position on the engine switch. Doing so may lead to a dead battery.

#### Note:

Connect the red and yellow lead wires to the terminals after wiring through the vehicle's fuse unit.

### ⚠ Connection Precautions

To prevent fuming and damage to the product, be sure to first securely connect the black lead wire (Ground) of this product to the metal part of the vehicle body. Connect separate black lead wires (Ground) for products with a high current consumption such as a power amplifier. When setting up connections all at once, there is a risk of fuming or damage to the product when screws loosen or come off completely.

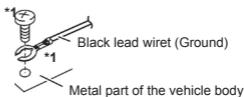

\*1 Not Supplied with the product

## Parking Mode

Parking Mode provides added security by monitoring your vehicle when it is parked, and the engine is turned OFF. This mode is especially useful for capturing video footage of incidents such as theft, vandalism, or collisions that may occur while your vehicle is unattended.

When activated, the dash camera enters a state of low power consumption and starts recording if vibration (detected by the G-sensor)

## Connecting to Dash Camera App

1. Scan the code for the Companion App on Google Play or App Store



2. Download the App
3. Select your language and then Agree to the terms & conditions.
4. Select your Dashcam Model (like VREC-Z410DH)
5. Ensure your Mobile's Bluetooth is turned on & once the dashcam is discovered tap on Connect to Dashcamera & Tap on Continue
6. Add Quick-Alert contact.

### Incase of connecting to Wi-Fi follow below steps:

1. Default Wi-Fi Name (SSID): Pioneer\_Z410DH\_XXXX
2. Default password: 12345678

### Note

- \* XXXX shall be a unique alphanumeric entity.
- Supports Android™ OS version 11 & above, iOS version 13 & above.

### Functionality based on use case :

Feature	Technology	Functionality
Live Video Streaming	Wi-Fi	View real-time footage from front/interior cameras via the Zenvue™ app.
Video Transfers to Phone		Download recordings to the app for playback/sharing.
Alert Message	Bluetooth	Sends Alert message to your Emergency contact with your GPS coordinates
App Configuration		Pair dashcam with the app for initial setup and settings adjustments (e.g., resolution, parking mode).
GPS Tagging & Incident Detection	None	Embed location/speed data in videos; auto-save crash footage via G-sensor.
Parking Mode		Record motion/impact events while parked (requires hardwiring kit).

## Trademarks and Copyrights

- USB Type-C<sup>®</sup> and USB-C<sup>®</sup> are registered trademarks of USB Implementers Forum.
- IOS is a trademark or registered trademark of Cisco in the U.S. and other countries and is used under license.
- App Store is a service mark of Apple Inc., registered in the U.S. and other countries and regions.
- Android and Google Play are trademarks of Google LLC.
- microSD, microSDHC and microSDXC Logos are trademarks of SD-3C LLC.

